

## Instruction for retrofitting reinforcement on Bavaria 40 AC in-mast furling

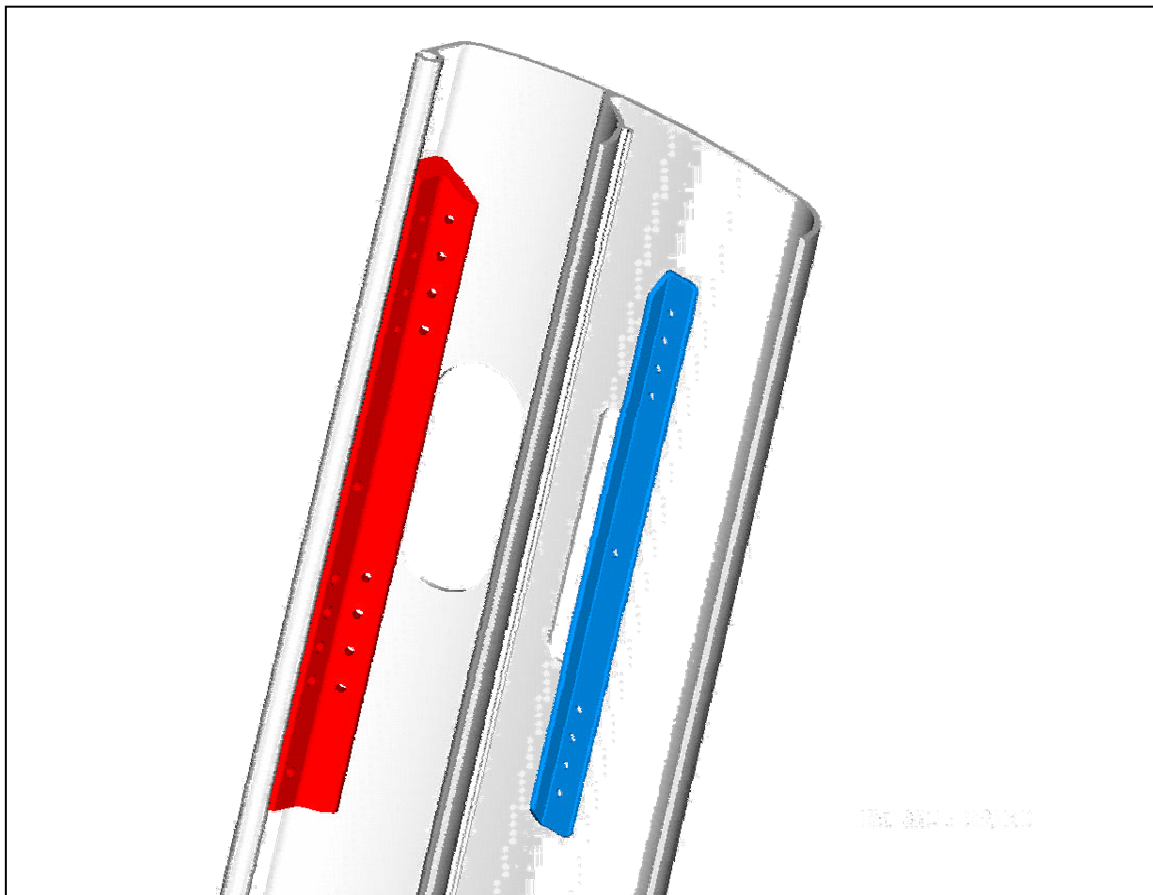

# Mounting Halyard Exit Reinforcement

Article no. 507-308

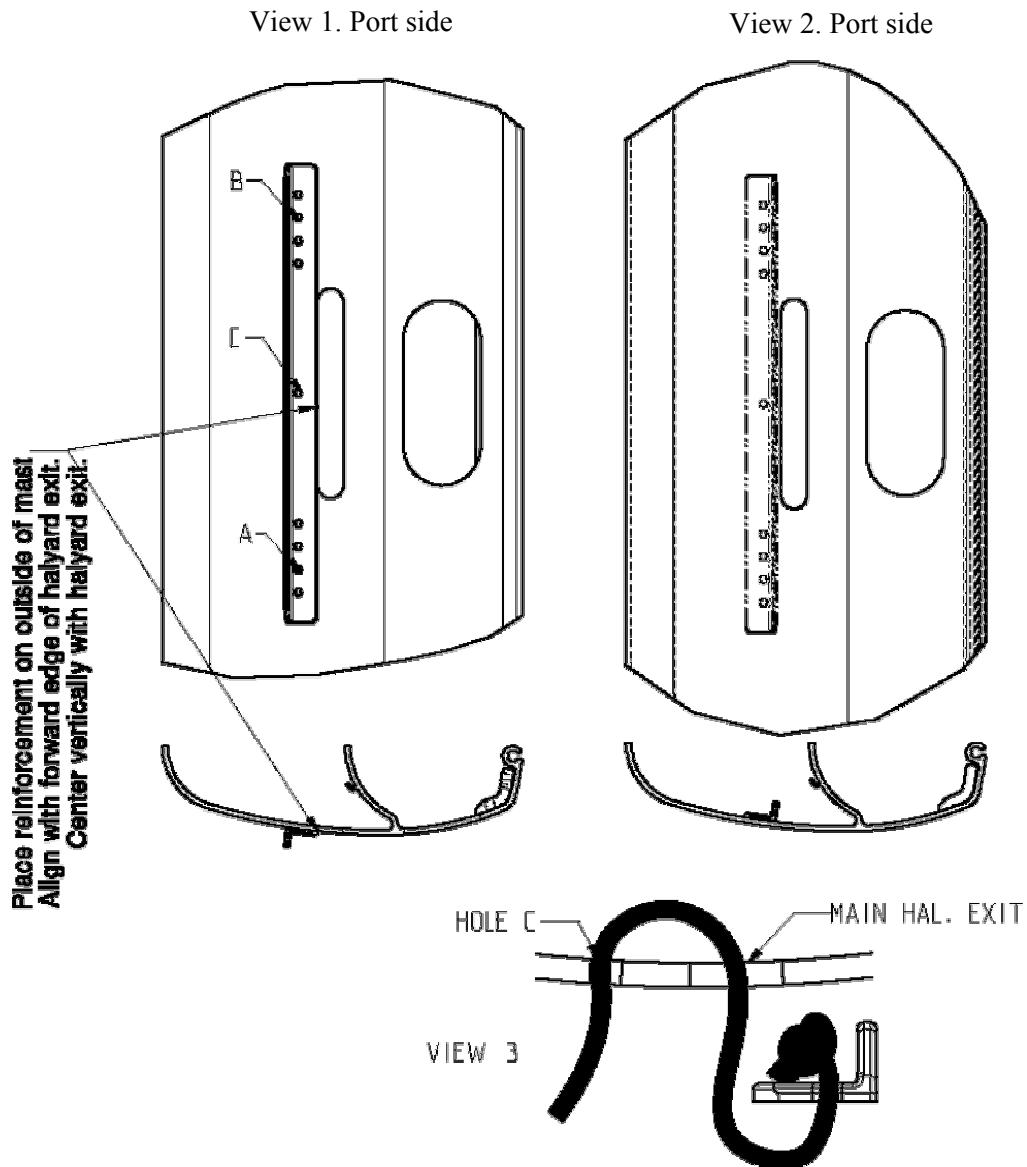

1. Remove any rope clutch that prevents your work.
2. Position 507-308 on outside of mast using adhesive tape, acc. to view 1.
3. Drill  $\varnothing$  4.9 mm holes at A & B.
4. Insert pop rivets in hole A & B, and fix the rivets with adhesive tape. **Do not rivet!**
5. Drill the remaining holes  $\varnothing$  4.9 mm.
6. Remove 507-308.
7. Check that inner mast surface and 507-308 are free from burrs.
8. Thread a messenger line through mast wall and 507-308 at hole C acc. to view 3.
9. Fit bracket on inside of mast wall acc. to view 2, and rivet all holes.
10. Punch all center-pins out of the rivets.

# Mounting aft reinforcement

Article no.: 507-304

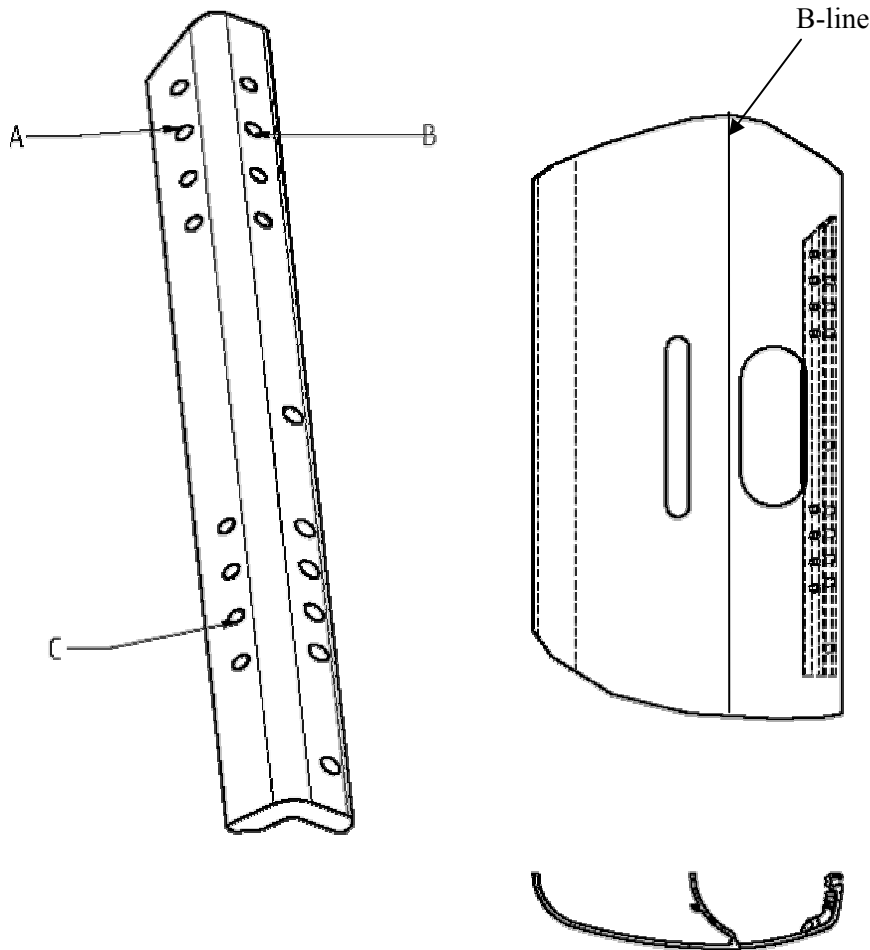

1. Insert a cloth through the access hole to protect the furling gear from chips.
2. Remove boom bracket rivets on port side using a  $\phi 6.5\text{mm}$  drill.
3. Mark hole positions on mast according to PS-409 using drill template 595-174.
4. Cut a hole through the drill template and position 507-304 acc. to PS-409. Secure with clamp, protect mast from scratches.
5. Drill holes A, B & C  $\phi 4.9\text{mm}$ .
6. Tap holes A, B & C through mast wall and 507-304 to M6 thread.
7. Remove 507-304 and drill hole A, B & C  $\phi 6.2\text{mm}$  in mast wall only.
8. Refit 507-304 and secure with M6 screws at A, B & C.
9. Drill all holes  $\phi 4.9\text{mm}$ , including boom bracket holes.
10. Drill Boom bracket holes  $\phi 6.5\text{mm}$ .
11. Tap all  $\phi 4.9\text{mm}$  holes in 507-304 to M6 thread.
12. Remove 507-304 and drill remaining holes in mast  $\phi 6.2\text{mm}$ .
13. Check that mast inner surface and 507-304 are free from burrs.
14. Refit 507-304 and fit all screws with locking adhesive.
15. Fix boom bracket with pop-rivets  $\phi 6.4\text{mm}$ .
16. Remove the cloth.

## Required equipment (not supplied)

Hand drilling machine  
Torx spanner T30  
Tap handle  
Pop rivet plier  
Screw clamp  
Hammer

## Equipment included:

Adhesive tape  
Drillbit  $\phi 4,9\text{mm}$   
Drillbit  $\phi 6,2\text{mm}$   
Drillbit  $\phi 6,5\text{mm}$   
Tap M6  
Messenger line  
Locking adhesive