

REPLACING PUMP LEVER PIN, HTI TENSIONERS W8/10, KIT 166-402-10 AND 172-529-10

There are two versions of the HTI tensioners. These have a differing pump piston and pump lever pin design, why the disassembly process varies somewhat between the two versions. The switch between the two versions was made in 2019. Therefore, there are two pump lever pin replacement kits.

166-402-10 with a 48mm long pin for the newer version.

172-529-10 with a 57mm long pin for the older version.

Tools

- Hex wrenches (Allen keys)
- A pair of pliers
- A small screwdriver
- Hammer

Identifying HTI tensioner version

Identifying your HTI tensioner version can easily be done by looking at the pump lever pin.

- If the pin is secured with hex screws on the ends, it is the newer version.
- If the pin is secured with circular clips (no hex screws on the ends), it is the older version.

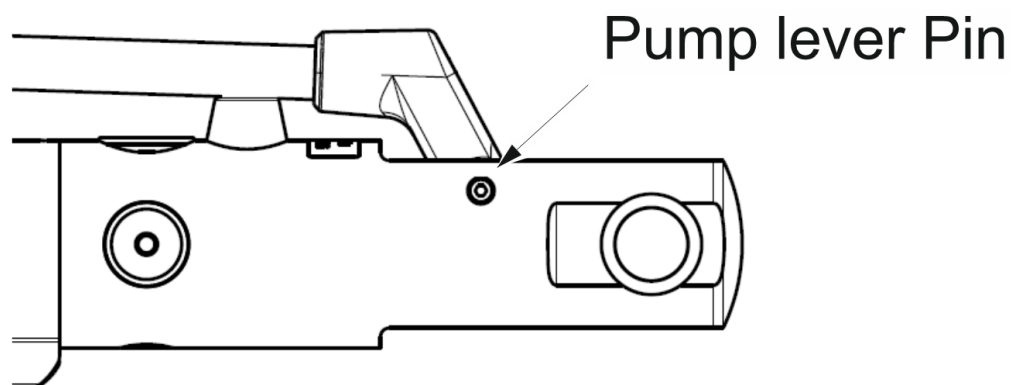

Releasing pressure before disassembly (both versions)

1. Open the release valve and pull the rod out

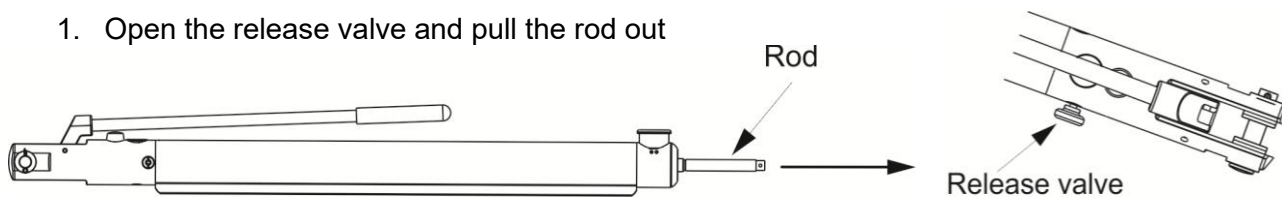

2. Place the oil plug as the highest point, open it carefully with the 8mm hex wrench (to make sure there is no pressure inside)

3. Close it again

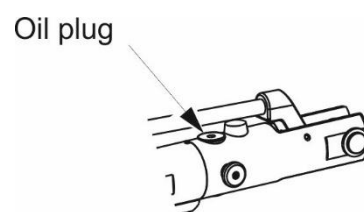

Removal of pin and handle (old version)

1. Remove the two Circular clips that hold the shaft for the handle in place, use a pair of pliers or a screwdriver.

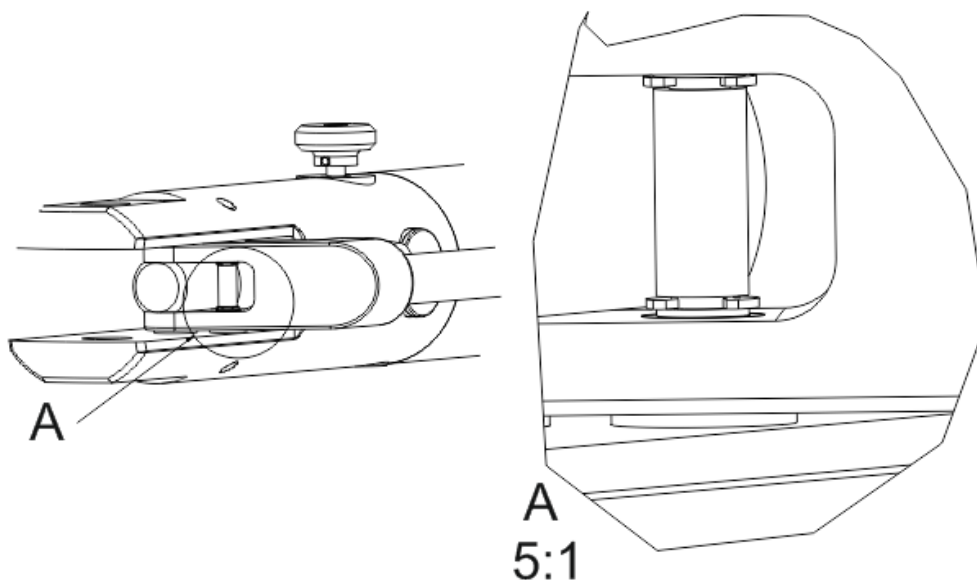

2. Remove the shaft that holds the handle

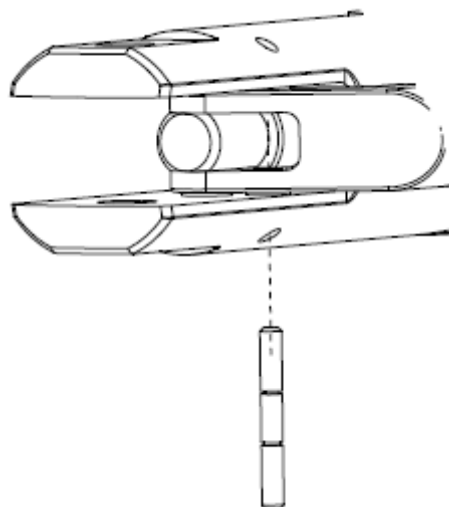

3. Fold out the handle and push it towards the body of the tensioner to remove it. Be careful not to lose the piston pin also located in the handle body.

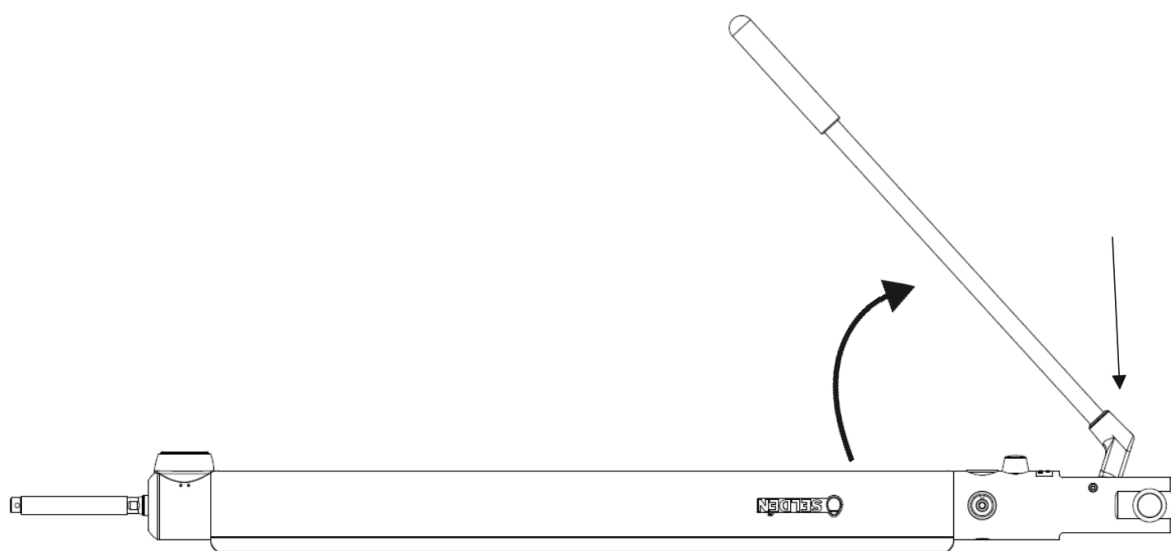

Note: The piston does not need to be removed for the older version.

Removal of pin and handle (new version)

1. Unscrew the screws that are locking the shaft in place.

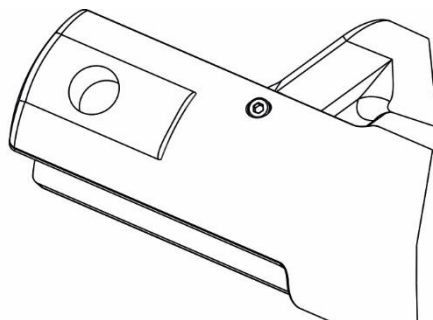

2. Remove the shaft.

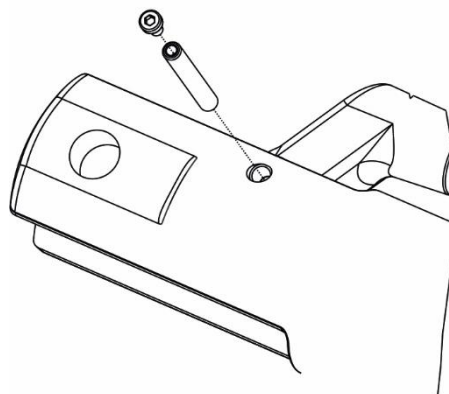

3. Remove the handle and the piston by gently hitting the end of the handle with a hammer.

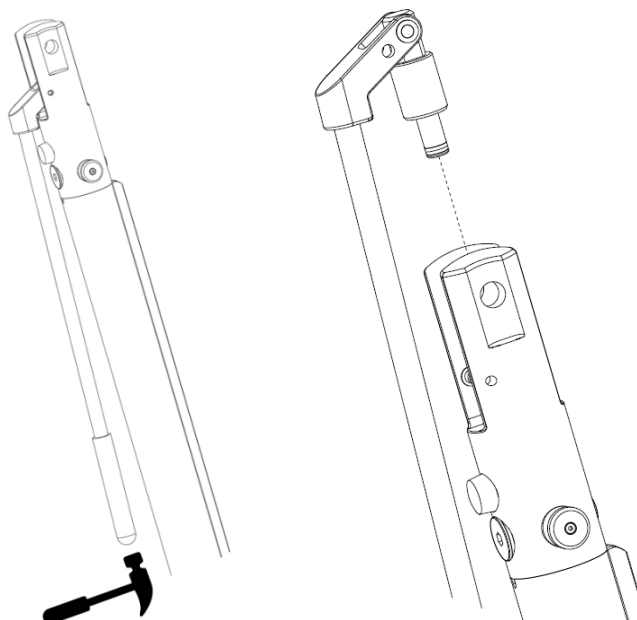

Place tensioner in a vertical position with piston up, before removing the piston to avoid oil leaking out

Replacing pump lever pin bushings (both versions)

1. Remove the old pump lever pin bushings (the smaller ones) by tapping them out from the inside using a screwdriver or hex wrench and a hammer.

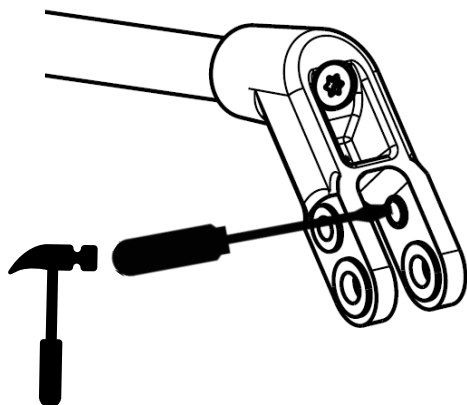

2. Install the new bearings included in the kit by gently tapping them in using a hammer.

Reassembly of piston (new version)

1. Mount the piston to the handle body with the piston pin.
2. Due to the tight fit between the piston and the sealings in the cylinder, the piston might need to be forced into place. Use a piece of wood or similar and place on the piston and tap it gently with a hammer.

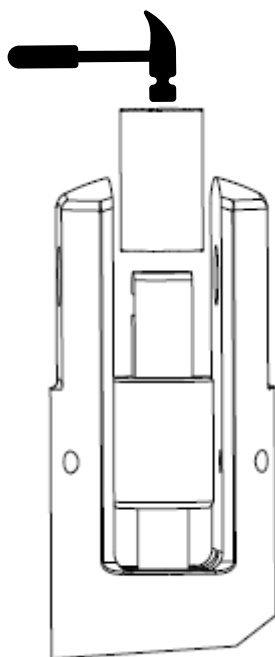

Assembly

1. Assemble the parts in the reversed order as they were disassembled.
2. Mount one of the screws in the pump lever pin using the supplied thread locker.
3. Mount the pin in the tensioner and secure it with the other screw using thread locker.

Removal of trapped air (if the piston has been removed)

1. Close the release valve
2. With the tensioner in a **vertical** position, operate the pump lever until the rod is contracted to its inward end position
3. Open the release valve
4. With the tensioner in a **vertical** position, operate the pump lever back and forth approximately 10 times slowly
5. With tensioner in **horizontal** position, pull the rod out. Handel downwards
6. Close the release valve
7. With tensioner in **vertical** position, operate the pump lever until the rod is contracted to its inward end position
8. Open the release valve
9. With tensioner in **vertical** position, operate the pump lever back and forth approximately 10 times slowly

