

Illuminated Push button (IP 67) Ø35mm

540-457-../540-459-../540-460-..

Dimensions:

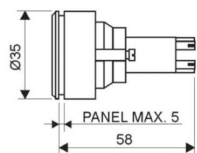

Mounting dimension WITHOUT PANEL

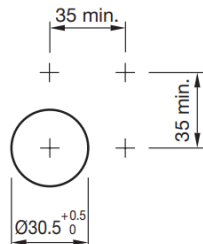

SELDÉN PANEL 2x
540-462-01
100x56x3mm

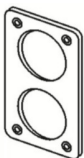

SELDÉN PANEL 1x
540-461-01
56x56x3mm

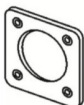

Mounting dimension with
Seldén panel 540-462-01

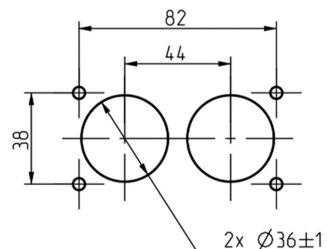

SELDÉN RAISED PANEL
540-482
96x53x9mm



Recommended screws:
2xMLC6S M5

Mounting dimension with
Seldén Raised panel 540-482:

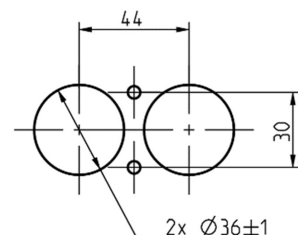

WIRING

Plug-in terminal: 2,8x0,5

Position 3 and 4 (Normally Open)
Control cables (from SEL-Bus converter or control box) must be connected to position 3 and 4.

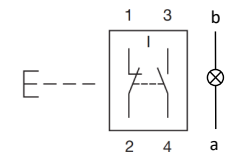

Position a and b (Button back lighting, light bulb)
Back lighting, which is optional, is preferably connected to the nav-lights circuit (12-24V).

Position 1 and 2 (Normally Closed)
DO NOT USE.

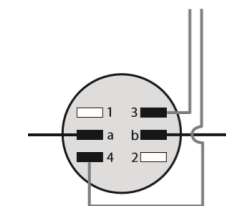

INSTALLATION WITH PANEL

1.

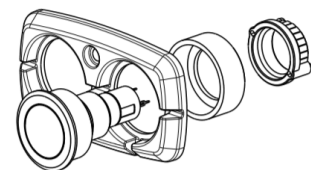

2.

