







Luff assembly for rod stay Furlex 204/304

Replacing section 3.1 in Furlex manual, 597-132-E and section 4.1 in manual 597-418-E.

At this point the top luff section "D" and the top distance tube "E" should be cut to length according to the respective manuals.

Luff assembly should be carried out on a clean, flat surface. Make sure there is enough space for the entire forestay length to be stretched out. Note that luff extrusions, joining sleeves and distance tubes must be fed from the top.

<p>1. Stretch out the rod stay on a flat, clean surface.</p>
<p>2. Start by feeding the lower short luff extrusion onto the forestay from the top. Orient extrusion as shown.</p> <div data-bbox="619 831 1043 1003"><p>Furlex S → </p><p>Furlex TD → </p></div>
<p>3. Also feed the short distance tube from the top. The distance tubes are welded shut but are easily opened by hand. Note the correct orientation of the distance tube - hinge to be sideways.</p> <div data-bbox="316 1160 895 1234"></div> <div data-bbox="1118 1077 1254 1234"></div>
<p>4. Add the long(204: 260mm/304: 325mm) joining sleeve. Feed from the top.</p> <div data-bbox="1002 1272 1417 1435"></div>
<p>5. Add a 2400 mm luff extrusion and a long distance tube. Make sure the distance tube is oriented correctly and add a short joining sleeve.</p>
<p>6. Fit the long connecting plate.</p> <div data-bbox="240 1637 1362 1749"></div>
<p>7. Using the short joining sleeve, push in the distance tube in the 2400mm extrusion so that the long joining sleeve is centered as shown. The short joining sleeve should enter the 2400mm extrusion by half its length.</p> <div data-bbox="363 1928 1278 2018"></div>

8. Repeat for the remaining 2400 mm luff extrusions and build the luff towards the top. Use short joining sleeves only. Finish off with the top extrusion and the top distance tube. Push the top distance tube 100 mm in to the extrusion



9. Snap on the sail feeder connector and put the sail feeder in position. Secure with the screw and tighten moderately.

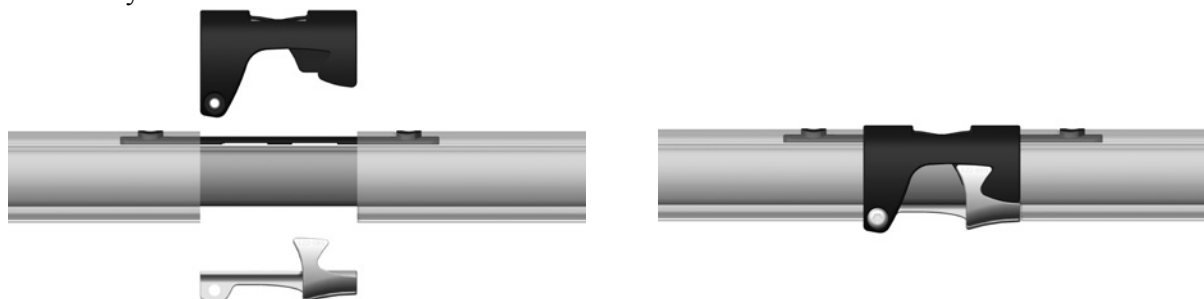

10. Fit the halyard swivel from the top and slide it down until it stops on top of the sail feeder. Then fit the top guard and push it into the top luff extrusion until it stops. Secure it with the two pre-fitted screws. Tighten the screws until they bottom, but do not over-tighten.

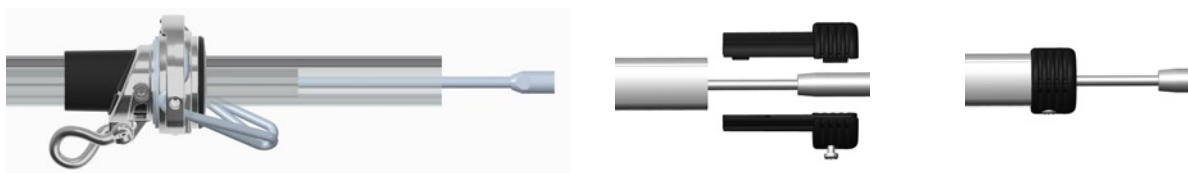

11. Fit the bearing plug halves as shown.

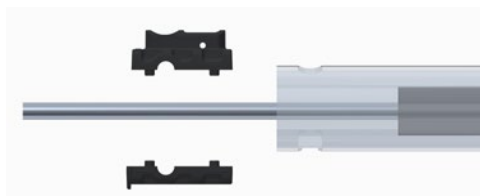

204/304S



- Fit the bearing halves in the lower extrusion as shown. Secure halves with the spring pin (A).

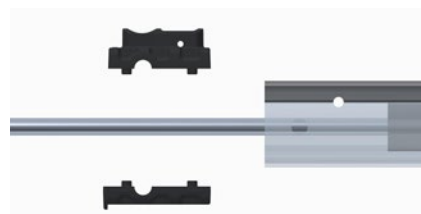

204/304TD



12. Screw the upper eye onto the socket and secure with the small grub screw.
Use locking adhesive for a permanent fit!



This completes the luff assembly. Next step is to fit the lower eye terminal to the stay. Go back to the Furlex manual 597-132 and continue from section 3.4.